

REV	REVISION				
	DRAWN BY:	CHK BY:	APPRD. BY:	EN:	DATE:
1	R. Leeney	—	R. Klingerman	PRE-1	02-10-25
	DRAWN BY:	CHK BY:	APPRD. BY:	EN:	DATE:

BOM: BKR0632_REV-1 Kit, Install, BKR0355			
ITEM	PART NUMBER	DESCRIPTION	QTY
1	1400-31221-500	Mounting Bracket, Steel, Black, BKR0355	1.00 EA
2	2820-31221-700	Screw, Machine, M3x0.5x8mm, PH	1.00 EA
3	2820-31222-100	Screw, Flanged, 18-8, Hex	4.00 EA
4	KAA0602P	Cable Kit, 10 ft. Hard Wire, Fused	1.00 EA

INSTALLATION

CHOOSE EITHER THE VERTICAL OR HORIZONTAL MOUNTING OPTION. PLAN YOUR INSTALLATION CAREFULLY. DO NOT LOCATE THE CHARGER IN A POSITION THAT INTERFERES WITH A SAFE OPERATION OF THE VEHICLE. ONCE THE EQUIPMENT LOCATION IS CHOSEN, DETERMINE THE BEST ROUTING FOR CABLES AND WIRES TO CONNECT THE SYSTEM. USE A RUBBER GROMMET TO PROTECT THE WIRES WHEN PASSING THROUGH SHEET METAL. AVOID ANY ROUTE THAT SUBJECTS THE WIRE TO PINCHING, CUTTING OR HIGH HEAT FROM THE ENGINE OR OTHER VEHICLE COMPONENT.

THE CHARGER CAN BE USED WITH A 12 VOLT, NEGATIVE GROUND ELECTRICAL SYSTEM.

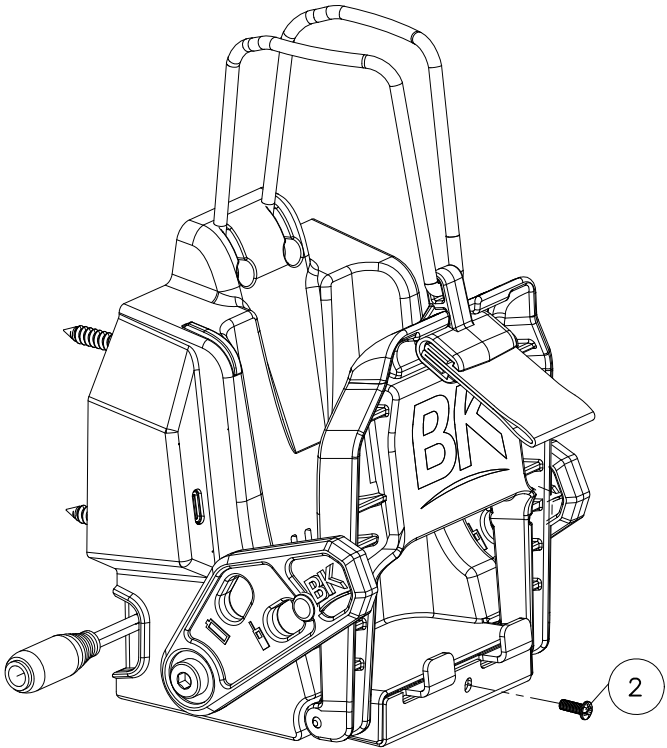
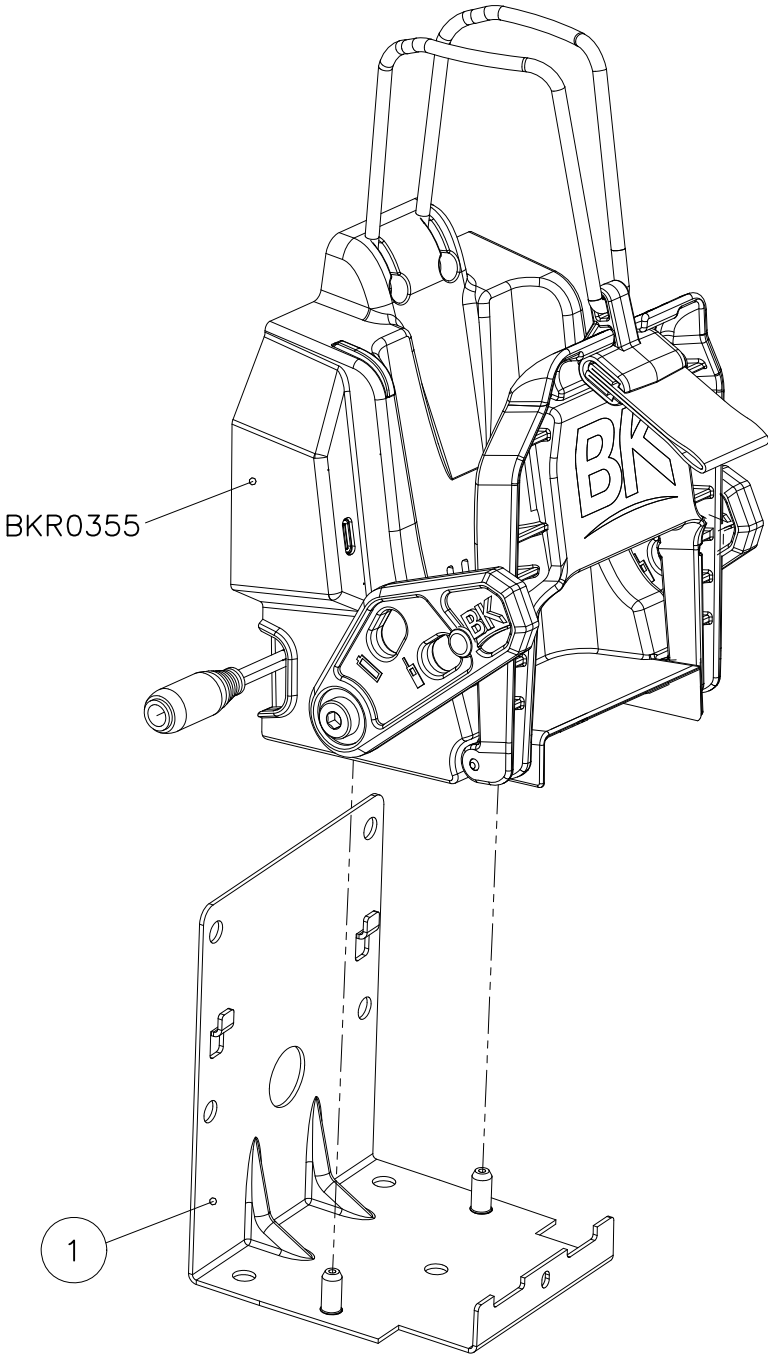
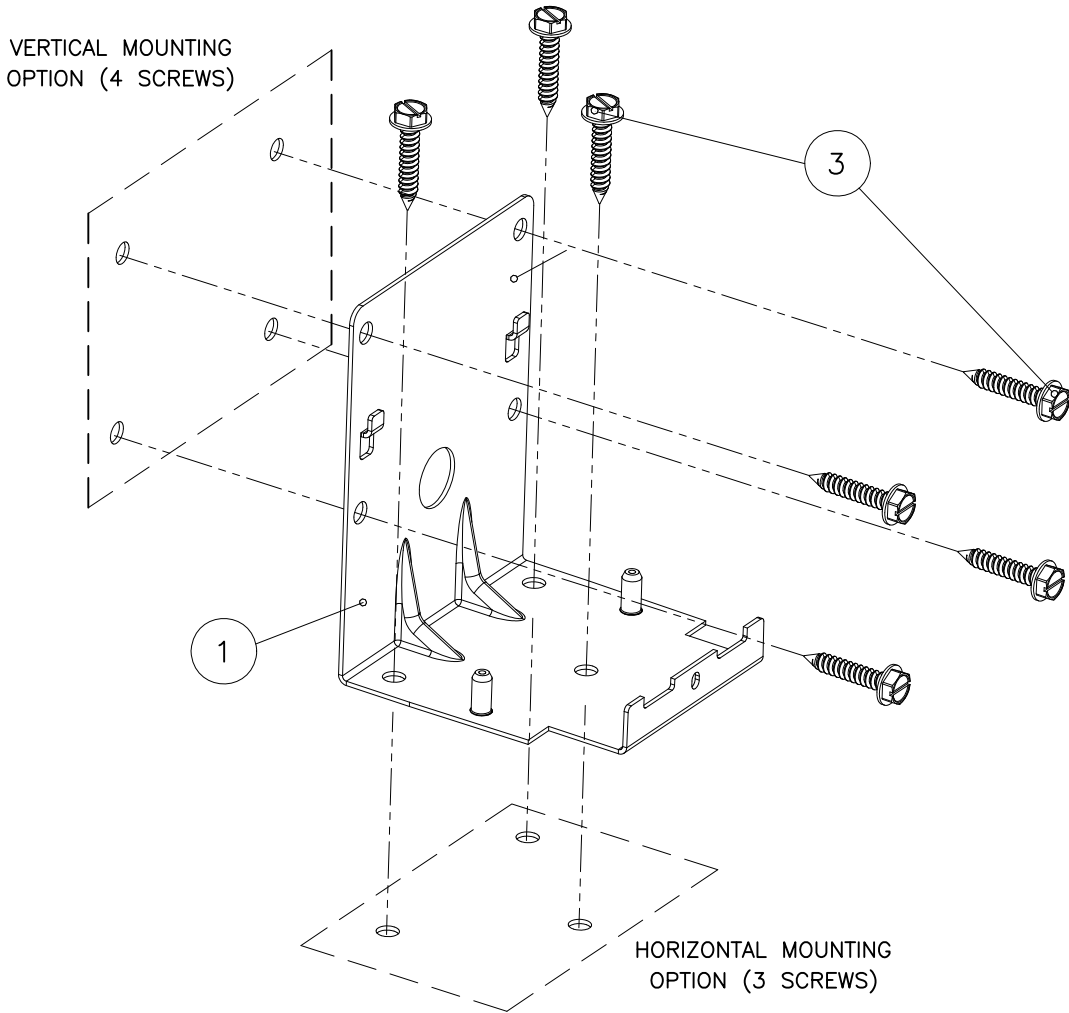

THIS DRAWING IS PROPERTY OF BK TECHNOLOGIES AND SHALL NOT BE REPRODUCED, COPIED OR USED AS THE BASIS FOR MANUFACTURE OR SALE OF PRODUCTS WITHOUT PERMISSION. UNLESS OTHERWISE SPECIFIED DIMENSIONS ARE IN INCHES AND INCLUDE APPLIED FINISH TOLERANCES			BK TECHNOLOGIES WEST MELBOURNE, FL. 32904	
TOLERANCES 2 PLACE DIM. 3 PLACE DIM. ANGLES ±.02 ±.005 ±1/2° SCREW THREADS-AMERICAN NATIONAL CLASS CLASS-			TITLE: INSTALLATION INSTRUCTIONS, BKR0355	
THIRD ANGLE PROJECTION			SIZE B	DRAWING NO.: 7005-31224-500
SCALE: NONE			REFERENCE: BKR0355	SHEET: 1 OF 2

KAA0602P
HARDWIRE KIT FOR IN-VEHICLE CHARGERS



CABLE SECTIONS	DESCRIPTION	LENGTH	NOTES
1 TO 2	CHARGER CABLE	36"	BEFORE SECURING CHARGER, CHECK CABLE LENGTHS TO ENSURE THEY ARE LONG ENOUGH TO REACH THE VEHICLE BATTERY OR OTHER POWER SOURCE. CABLE WIRE AND COMPONENTS RATED FOR 15A
2 TO 3 / 2 TO 5	MAIN CABLE	96" / 120"	
3 TO 6	FUSE CABLE	24"	

REFERENCE	DESCRIPTION / INSTALLATION INFORMATION
1	PLUGS INTO CHARGER BASE.
2	CONNECTOR ALLOWS SEPARATE ROUTING OF MAIN CABLE BEFORE ATTACHING TO CHARGER CABLE.
3	CONNECTOR ALLOWS MAIN CABLE TO BE ROUTED THROUGH FIREWALL OR OTHER SMALL OPENINGS BEFORE ATTACHING TO FUSE.
4	HOLDER FOR REPLACEABLE BLADE FUSE. US THE 3A FUSE WITH BKR0355.
5	RING CONNECTOR IS PACKED SEPARATELY. CRIMP ONTO END OF BLACK WIRE (NEGATIVE). IF ATTACHED TO NEGATIVE BATTERY TERMINAL, INSTALL INLINE FUSE (NOT INCLUDED).
6	RING CONNECTOR IS PACKED SEPARATELY. CRIMP ONTO END OF RED WIRE (POSITIVE). ATTACHED TO POSITIVE BATTERY TERMINALOR A 12V / 24V SWITCHED POWER SOURCE.

INSTALLATION TIP

WHEN ROUTING CABLES THROUGH THE VEHICLE, FIREWALL OR ENGINE COMPARTMENT, MAKE SURE THEY ARE SECURED AND / OR REINFORCED TO PREVENT CHAFFING OF THE WIRE INSULATION. KEEP CABLES AWAY FROM SOURCES OF HEAT IN THE ENGINE COMPARTMENT

THIS DRAWING IS PROPERTY OF BK TECHNOLOGIES AND SHALL NOT BE REPRODUCED, COPIED OR USED AS THE BASIS FOR MANUFACTURE OR SALE OF PRODUCTS WITHOUT PERMISSION.		BK TECHNOLOGIES WEST MELBOURNE, FL. 32904	
UNLESS OTHERWISE SPECIFIED DIMENSIONS ARE IN INCHES AND INCLUDE APPLIED FINISH TOLERANCES		TITLE: INSTALLATION INSTRUCTIONS, BKR0355	
TOLERANCES 2 PLACE DIM. 3 PLACE DIM. ANGLES ±.02 ±.005 ±1/2° SCREW THREADS-AMERICAN NATIONAL CLASS CLASS-		DRAWING NO.: 7005-31224-500	
THIRD ANGLE PROJECTION		SIZE B	REFERENCE: BKR0355
SCALE: NONE		SHEET: 2 OF 2	