

4

3

2

1

| REV | REVISION  |         |               |       |          |
|-----|-----------|---------|---------------|-------|----------|
|     | DRAWN BY: | CHK BY: | APPROD. BY:   | EN:   | DATE:    |
| 1   | R. Leeney | —       | R. Klingerman | PRE-1 | 09-16-25 |
|     | DRAWN BY: | CHK BY: | APPROD. BY:   | EN:   | DATE:    |

| BOM: BKR0632_REV-1<br>Kit, Install, BKR0355 |                |   |         |
|---|----------------|---|---------|
| ITEM  | PART NUMBER    | DESCRIPTION                             | QTY     |
| 1   | 1400-31221-500 | Mounting Bracket, Steel, Black, BKR0355 | 1.00 EA |
| 2   | 2820-31221-700 | Screw, Machine, M3x0.5x8mm, PH          | 1.00 EA |
| 3   | 2820-31222-100 | Screw, Flanged, 18-8, Hex               | 4.00 EA |
| 4   | KAA0602P       | Cable Kit, 10 ft. Hard Wire, Fused      | 1.00 EA |

INSTALLATION

CHOOSE EITHER THE VERTICAL OR HORIZONTAL MOUNTING OPTION. PLAN YOUR INSTALLATION CAREFULLY. DO NOT LOCATE THE CHARGER IN A POSITION THAT INTERFERES WITH A SAFE OPERATION OF THE VEHICLE. ONCE THE EQUIPMENT LOCATION IS CHOSEN, DETERMINE THE BEST ROUTING FOR CABLES AND WIRES TO CONNECT THE SYSTEM. USE A RUBBER GROMMET TO PROTECT THE WIRES WHEN PASSING THROUGH SHEET METAL. AVOID ANY ROUTE THAT SUBJECTS THE WIRE TO PINCHING, CUTTING OR HIGH HEAT FROM THE ENGINE OR OTHER VEHICLE COMPONENT.

THE CHARGER CAN BE USED WITH A 12 VOLT, NEGATIVE GROUND ELECTRICAL SYSTEM.

VERTICAL MOUNTING  
OPTION (4 SCREWS)

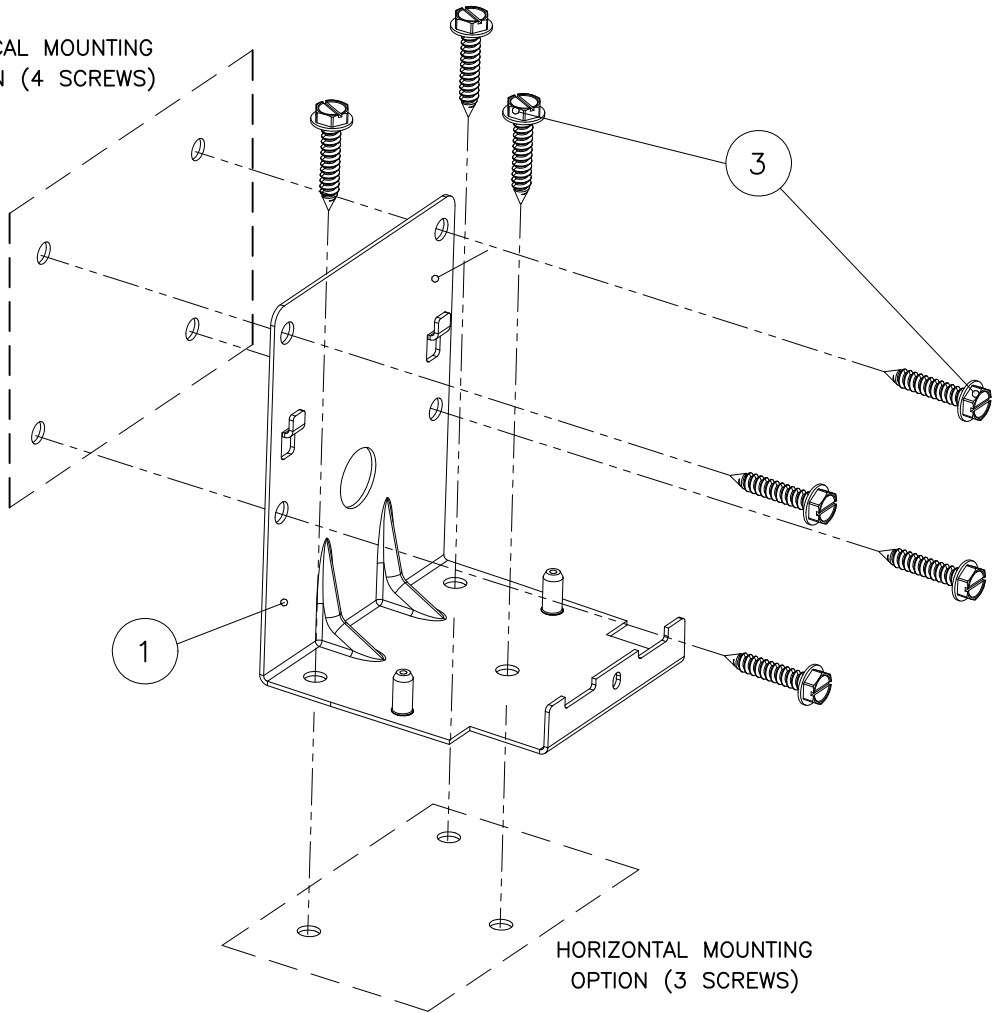

BKR0355

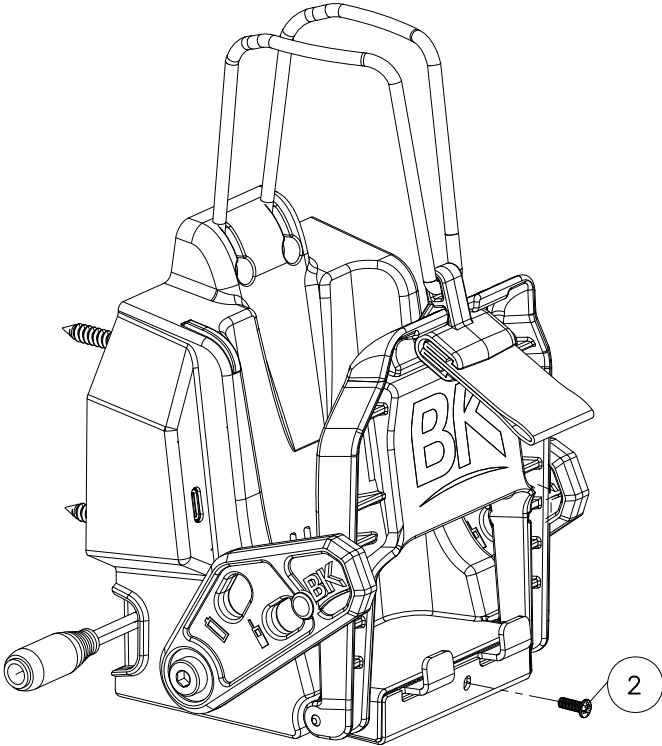
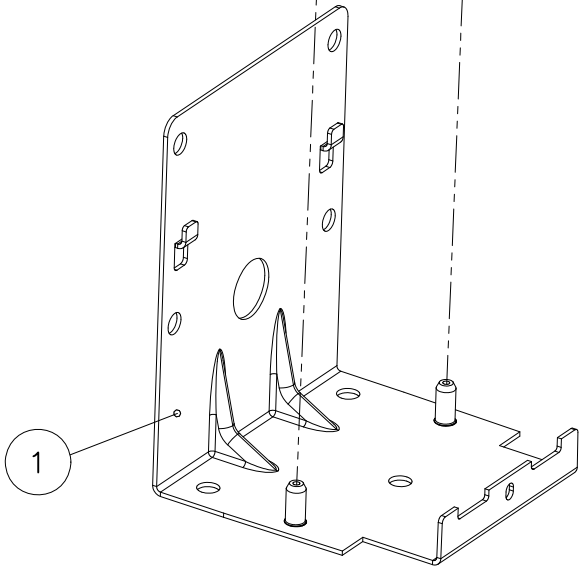

4

3

2

1

|  |  |  |  |
|--|--|--|--|
| THIS DRAWING IS PROPERTY OF BK TECHNOLOGIES AND SHALL NOT BE REPRODUCED, COPIED OR USED AS THE BASIS FOR MANUFACTURE OR SALE OF PRODUCTS WITHOUT PERMISSION. |  | BK TECHNOLOGIES<br>WEST MELBOURNE, FL. 32904 |  |
| UNLESS OTHERWISE SPECIFIED DIMENSIONS ARE IN INCHES AND INCLUDE APPLIED FINISH TOLERANCES  |  | TITLE:<br>INSTALLATION INSTRUCTIONS, BKR0355 |  |
| TOLERANCES<br>2 PLACE DIM. 3 PLACE DIM. ANGLES<br>±.02 ±.005 ±1/2°   |  | DRAWING NO.:<br>BKR0632                      |  |
| SCREW THREADS—AMERICAN NATIONAL CLASS—   |  | SCALE:<br>NONE                               |  |
| THIRD ANGLE PROJECTION   |  | REFERENCE:<br>BKR0355                        |  |
|  |  | SHEET:<br>1 OF 2                             |  |

KAA0602P  
HARDWIRE KIT FOR IN-VEHICLE CHARGERS

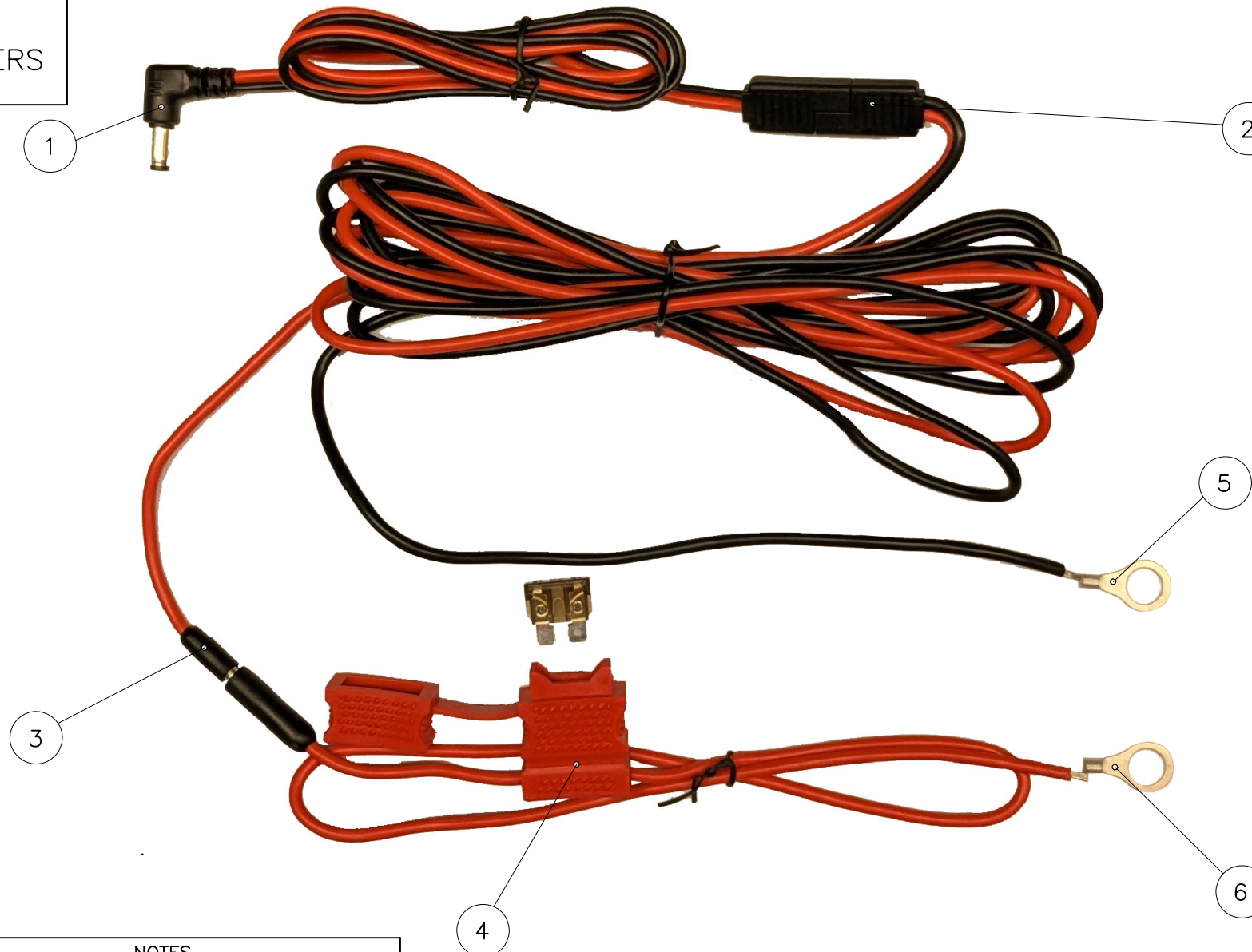

| CABLE SECTIONS  | DESCRIPTION   | LENGTH     | NOTES   |
|-----------------|---------------|------------|---|
| 1 TO 2          | CHARGER CABLE | 36"        | BEFORE SECURING CHARGER, CHECK CABLE LENGTHS TO ENSURE THEY ARE LONG ENOUGH TO REACH THE VEHICLE BATTERY OR OTHER POWER SOURCE. CABLE WIRE AND COMPONENTS RATED FOR 15A |
| 2 TO 3 / 2 TO 5 | MAIN CABLE    | 96" / 120" |   |
| 3 TO 6          | FUSE CABLE    | 24"        |   |

| REFERENCE | DESCRIPTION / INSTALLATION INFORMATION  |
|-----------|---|
| 1         | PLUGS INTO CHARGER BASE.  |
| 2         | CONNECTOR ALLOWS SEPARATE ROUTING OF MAIN CABLE BEFORE ATTACHING TO CHARGER CABLE.  |
| 3         | CONNECTOR ALLOWS MAIN CABLE TO BE ROUTED THROUGH FIREWALL OR OTHER SMALL OPENINGS BEFORE ATTACHING TO FUSE.   |
| 4         | HOLDER FOR REPLACEABLE BLADE FUSE. US THE 3A FUSE WITH BKR0355.   |
| 5         | RING CONNECTOR IS PACKED SEPARATELY. CRIMP ONTO END OF BLACK WIRE (NEGATIVE). IF ATTACHED TO NEGATIVE BATTERY TERMINAL, INSTALL INLINE FUSE (NOT INCLUDED). |
| 6         | RING CONNECTOR IS PACKED SEPARATELY. CRIMP ONTO END OF RED WIRE (POSITIVE). ATTACHED TO POSITIVE BATTERY TERMINALOR A 12V / 24V SWITCHED POWER SOURCE.      |

INSTALLATION TIP

WHEN ROUTING CABLES THROUGH THE VEHICLE, FIREWALL OR ENGINE COMPARTMENT, MAKE SURE THEY ARE SECURED AND / OR REINFORCED TO PREVENT CHAFFING OF THE WIRE INSULATION. KEEP CABLES AWAY FROM SOURCES OF HEAT IN THE ENGINE COMPARTMENT

|  |  |  |                         |
|--|--|--|-------------------------|
| THIS DRAWING IS PROPERTY OF BK TECHNOLOGIES AND SHALL NOT BE REPRODUCED, COPIED OR USED AS THE BASIS FOR MANUFACTURE OR SALE OF PRODUCTS WITHOUT PERMISSION. |  | BK TECHNOLOGIES<br>WEST MELBOURNE, FL. 32904 |                         |
| UNLESS OTHERWISE SPECIFIED DIMENSIONS ARE IN INCHES AND INCLUDE APPLIED FINISH TOLERANCES  |  | TITLE:<br>INSTALLATION INSTRUCTIONS, BKR0355 |                         |
| TOLERANCES<br>2 PLACE DIM. 3 PLACE DIM. ANGLES<br>±.02 ±.005 ±1/2°<br>SCREW THREADS—AMERICAN NATIONAL CLASS—<br>CLASS—                                       |  | SIZE<br>B                                    | DRAWING NO.:<br>BKR0632 |
| THIRD ANGLE PROJECTION   |  | SCALE:<br>NONE                               | REFERENCE:<br>BKR0355   |
|  |  | SHEET:<br>2 OF 2                             |                         |